



CATALOG 2026



GLOBAL DECKING SYSTEM

As decking specialists for over 20 years, we are committed to developing sustainable, high-quality solutions on a daily basis. Cobra guarantees reliable, proven products that create value through innovations combining performance and environmental responsibility.

From the design stage onwards, we make a special effort to use recycled materials, reduce packaging, and cut fossil fuel consumption.

Our teams develop unique products such as Hybrid universal clips with integrated screws, which allow for faster installation of all types of decking boards without pre-drilling.

Our goal is to make deck construction more reliable and simpler by providing solutions such as the STRUCTURAL concept, a complete, versatile, and rot-proof aluminum joist system, our NIVO adjustable pedestals manufactured in France, and SPIRAL foundation screws, a flexible and eco-friendly alternative to concrete.

Fastening, precision, ventilation, stability, waterproofing, drainage... Cobra Fastener® helps increase the lifespan of your decking so that your deck lasts a long time.

FASTENERS 04

HYBRID clips
AIR SPACER wedge
COBRA fasteners
D-LOCK invisible fastener

STRUCTURES 28

STRUCTURAL aluminum joists
NIVO adjustable pedestals
SPIRAL Foundation screws

ACCESSORIES 64

BITUDECK strip
GEODECK geotextile felt
Installation aids
Wedges

FASTENERS

DECK CLIPS



3 TYPES / 3 SIZES

The result of extensive experience in decking design, the HYBRID clip is a unique and innovative invisible fastening system **compatible with many decking boards** available on the market.

Its dual-material design gives it exclusive technical characteristics and performance that guarantee perfect hold and impeccable stability over time. In addition, the uniqueness of this clip with its pre-installed screw makes installation easy and gives it unparalleled speed of **execution when used in combination with the Airspacer**.

The HYBRID range adapts and meets all needs with three sizes of self-drilling stainless steel screws that do not require **pre-drilling**.

Each decking board has its own clip. Each joist has its own screw.

HYBRID





FAST RELIABLE INNOVATIVE

- High tear resistance
- Controls decking movement
- Quick and easy installation with Power Grip
- Fastening to wood and aluminum joists
without pre-drilling

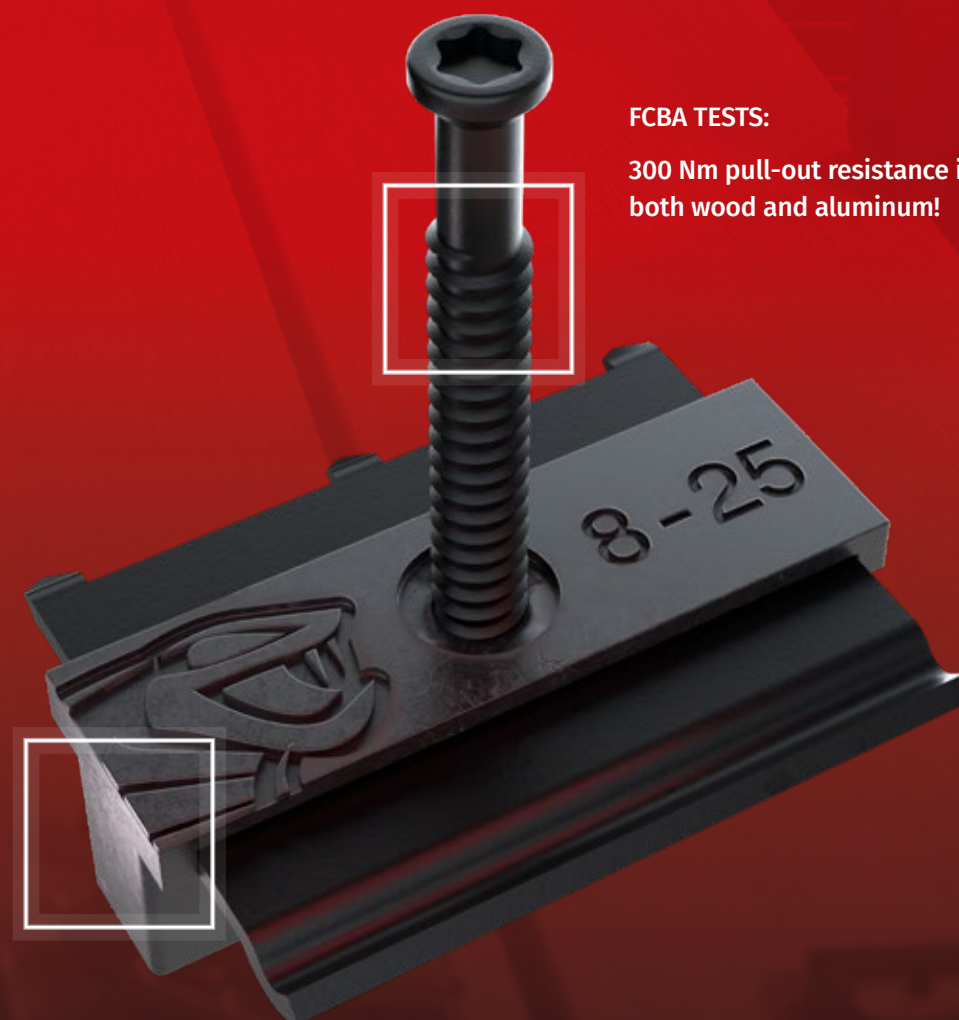

FCBA TESTS:

300 Nm pull-out resistance in
both wood and aluminum!

Design compatible with many
grooved board profiles



30 mm wide A2 stainless steel (AISI 304) wing for optimal support. Matt black anti-glare lacquer



C1 stainless steel screw (AISI 410) pre-fitted in the factory on the clip for faster installation. Torx drive for comfort and precision. Black lacquered head

Clip with claws to hold the board firmly in place



6 mm wide UV-resistant black polypropylene body ensuring appropriate and regular spacing between the boards

Self-drilling tip for fastening in wood or aluminum without pre-drilling

Honeycomb structure that absorbs dimensional variations in the decking



The Cobra HYBRID invisible fastening system for wood or composite decks offers **unique and exclusive technical features**. Cobra HYBRID guarantees perfect stability over time and extreme resistance to uplift, **exceeding the requirements of the NF DTU 51.4 standard** for fastening decking boards.

HYBRID 8-18 WPC & THERMO BOARDS

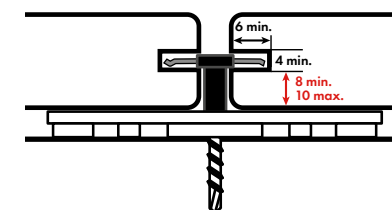

HYBRID 7-22 BAMBOU & THERMO BOARDS

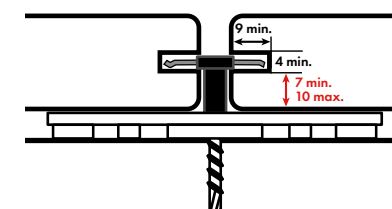

HYBRID 8-25 HARDWOOD BOARDS

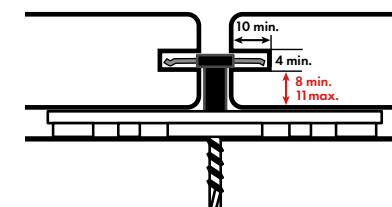
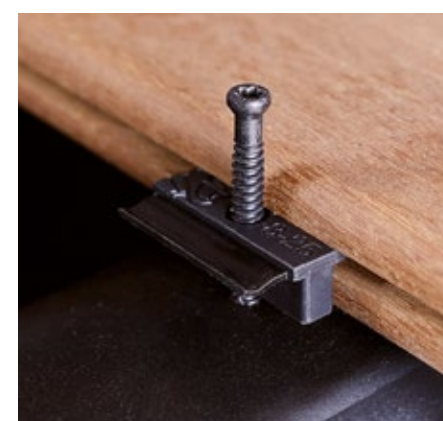

300 KG TEAR RESISTANCE

Tests carried out by FCBA with size L clips on Kapur boards laid on Kapur and aluminum joists.
No. 403/24/0541/B-1-V1.
February 2025



JOISTS



		ALUMINIUM	SOFT WOOD	TROPICAL WOOD 800KG/M3	TROPICAL WOOD 1000KG/M3
8-18					
S	FD1989	✓			
M	FD0993	✓	✓	✓	
L	FD1987	✓	✓	✓	✓
7-22					
S	FD2016	✓			
M	FD1334	✓	✓	✓	
L	FD1988	✓	✓	✓	✓
8-25					
L	FD0964	✓	✓	✓	✓



Stainless
steel C1

DRILLING
CAPACITY

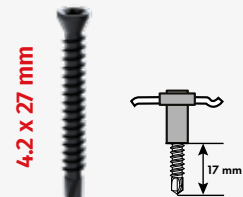
ALUMINUM joist
WOOD joist

	TX-15	TX-15	TX-20
			
	4,2 x 27 mm	4,2 x 35 mm	4,8 x 43 mm
S	3 mm		
M		3 mm	
L			4 mm
	NO	Up to 800 kg/m3	Up to 1000 kg/m3





Recommended
installation with **AIR
SPACER**
See p.18

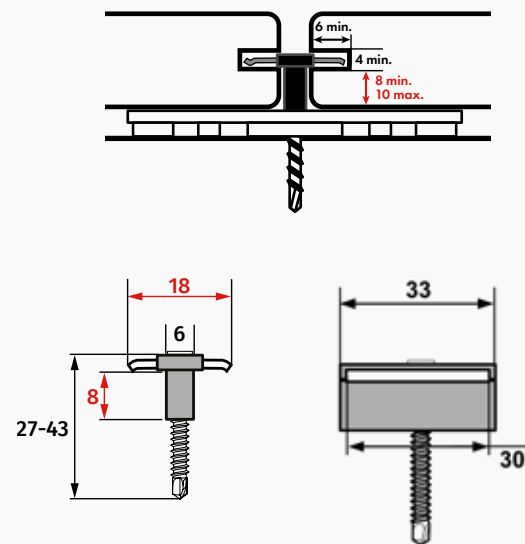

HYBRID 8-18 For WPC

8-18 S	FD1989
8-18 M	FD0993
8-18 L	FD1987



- Boxes of 90 clips
- 4 to 5 m²
- TX-15 screwdriver bit included

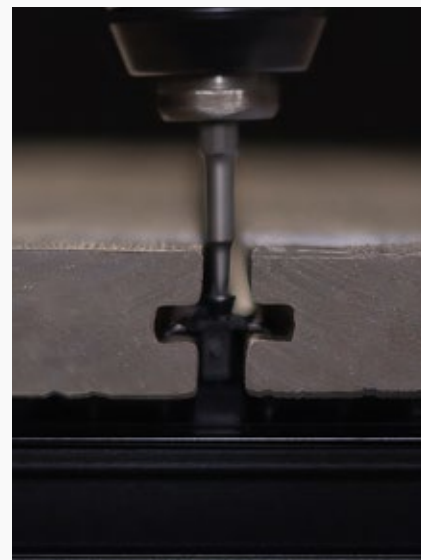



HYBRID 7-22

For bamboo

7-22 S	FD2016
7-22 M	FD1334
7-22 L	FD1988



- Boxes of 90 clips
- 4 to 5 m
- TX-15 screw tip included



Recommended
installation
with **AIR SPACER**
See p.18

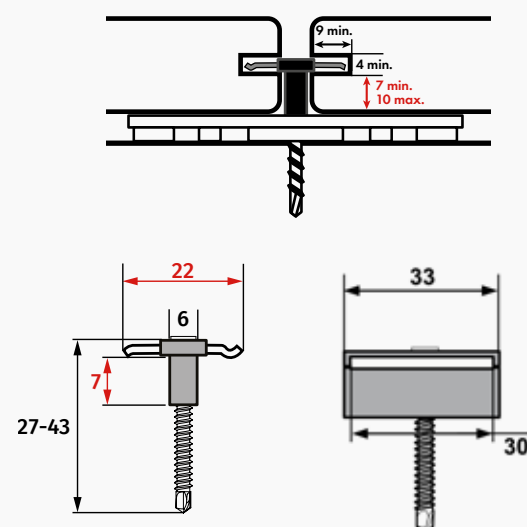

HYBRID CLIPS



Recommended
installation with
AIR SPACER
See p.18



HYBRID 8-25 For hardwoods

8-25L
FD0964



- Boxes of 90 clips
- 4 to 5 m²
- TX-20 screw cap included

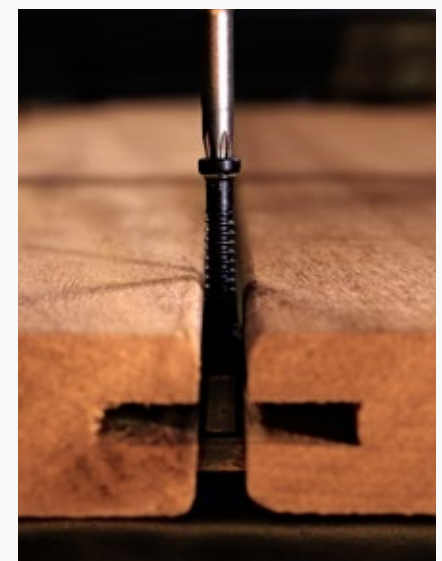
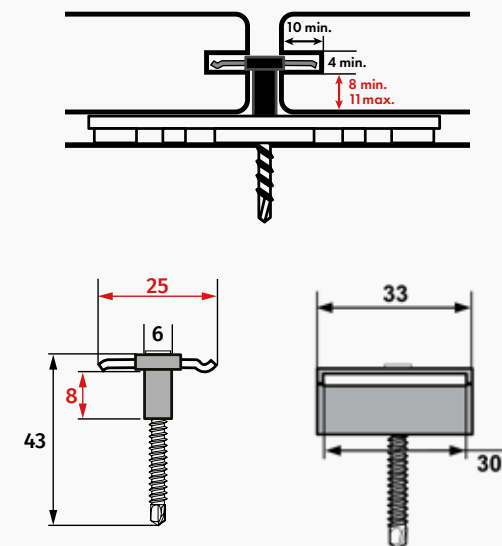

AIR SPACER

Ventilation spacer

FD1040

- Optimizes the installation of Hybrid clips
- Increases the lifespan of the deck
- Polypropylene
- UV, heat, and frost resistant
- Complies with DTU 51.4 requirements
- Can be cut by hand



The Airspacer promotes ventilation between the board and the joist without affecting the action of the fastening clip or the movement of the wood. Its design allows for perfect assembly with Cobra clips Hybrid clips for quick and easy installation.

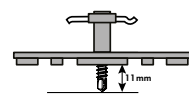

HYBRID **S**

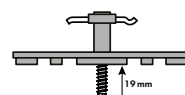

HYBRID **M**

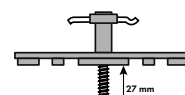

HYBRID **L**

Using the Airspacer **reduces** the effective screw length **by 6 mm**



Capacity

- 100 AIRSPACER®
- 4 Board spacers: DECKSPACER®

The Airspacer can be cut to size for installing FD0336 starter clips, for example

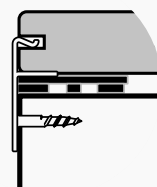
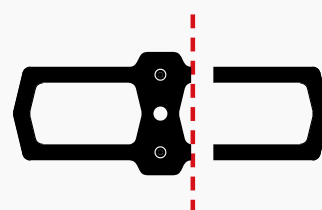



COBRA AIR START/END

Wood or aluminum battens

- Clip and self-drilling screw 4.2x32 mm in A2 stainless steel (AISI304) 30 pcs
- TX 20 bit included
- Suitable for use with Airspacer
- Vertical or lateral fastening
- Compatible with aluminum and wood battens
- Pre-drilling required

FD2274

x	y	z
8 mm	4 mm	10 mm

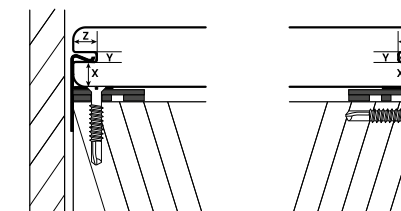

COBRA 20 START/END

Wooden battens

- Clips and screws 4.5x25 mm in A2 stainless steel (AISI304) 30 pcs
- R2 end cap included
- Anti-glare matte black color
- Vertical or side mounting
- Pre-drilling required

FD0336

x	y	z
8 mm	4 mm	10 mm

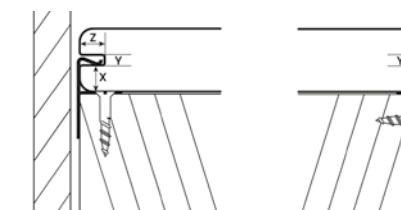

COBRA END

Universal end clip

- Clip and screw 4.5x25 mm in A2 stainless steel (AISI304) 30 pcs
- Anti-glare matte black color
- Fits all board heights
- Pre-drilling required

FD1432

x	y	z
All dimensions	4 mm	8 mm

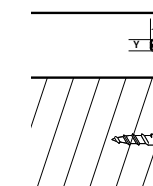



A2 STAINLESS STEEL SCREWS

Wooden battens

- AISI304 stainless steel screws
- Cutting thread for better penetration into wood
- Tapered tip to reduce wood splitting
- Knurled finish to facilitate screw insertion into wood
- Deep Torx drive to prevent bit rejection and slippage
- Pre-drilling required

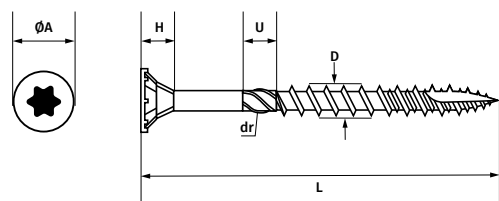

Code FR	A (mm)	L (mm)	U (mm)	D (mm)	dr (mm)	Torx	Quantity
0601	8	50	4	5	4	T25	200
0602	8	60	8	5	4	T25	200
0613	10	70	10	6	5	T30	100

Size 5x60 mm available with lacquered head

- 5 colors
- Bags of 50 screws

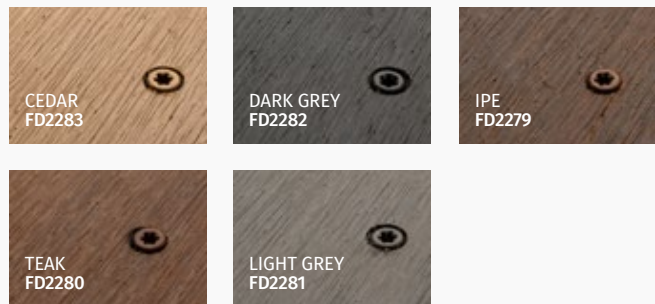

DECKING FASTENERS



A4 STAINLESS STEEL SCREWS

Aluminum decking

- A4 stainless steel screw, AISI316, suitable for areas highly exposed to corrosion
- Self-drilling tip for aluminum structures up to 3 mm thick
- Narrow, stepped screw head to reduce wood splintering
- Perfectly flush, optimal pressing
- Ideal for fastening finishing elements
- Pre-drilling required

FD2110 5.5x45mm (200pcs)

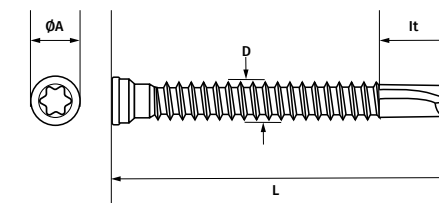

Size	A (mm)	L (mm)	D (mm)	It (mm)	Torx
M5.5 x 45	7,9 - 8	45	5,5	9,5	T20

Available with lacquered head

- 6 colors
- Bags of 50 screws

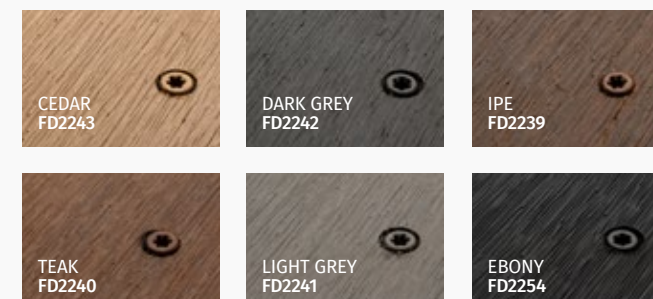



D-LOCK

Universal clip

FD0600

- Universal clip for decking boards 20 to 28 mm thick and 90 to 150 mm wide
- Fastening system suitable for decking boards without grooves
- Ensures ventilation under the board, in accordance with the requirements of DTU 51.4
- Robust and resistant to humidity and extreme temperatures
- Made from POM polymer material: polyoxymethylene
- Compatible with all decking and wooden structures, with pre-drilling required



INTERMEDIATE CLIP



START/END CLIP



CAPACITY

- 110 Fastening clips 3x60x8mm
- 15 Start/End clips
- 250 stainless steel screws : 4x25 mm
- 55 stainless steel screws: 4x40 mm
- 1 Metal drilling template
- 4 Board spacers: DECKSPACER®

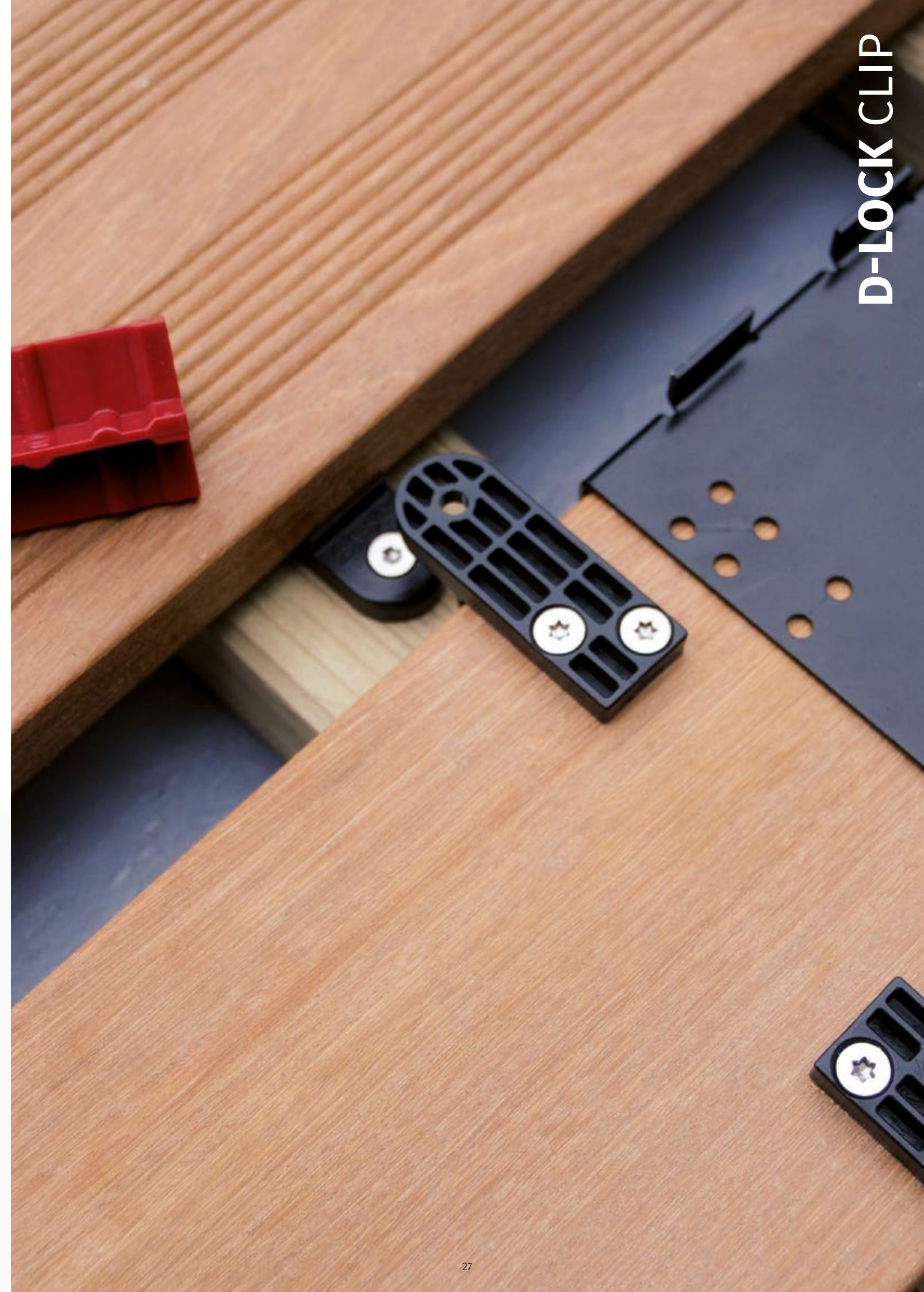
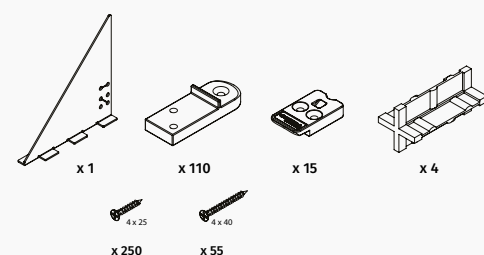
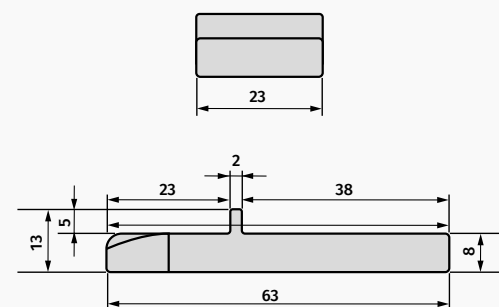

STRUCTURES

WOOD & CERAMIC DECKING



A DECK FOR LIFE!

The STRUCTURAL system provides you with a rot-proof structure that is completely resistant to moisture and mold, offering unmatched durability. These aluminum joists are suitable for all types of environments and conditions. Unlike wood, aluminum is not subject to deformation or deterioration of its qualities.

High-performance, lightweight load-bearing elements that are easy to handle, STRUCTURAL joists are perfectly suited for designing elevated structures on adjustable pedestals or foundation screws. STRUCTURAL can therefore be installed on hard, stabilized, loose, or impermeable ground.

Its modularity allows it to meet a wide range of requirements, whether for installing composite or wooden decking boards or laying porcelain stoneware paving.

STRUCTURAL





LIGHT STABLE DURABLE

- Rot-proof
- Quick and easy assembly
- Excellent mechanical strength
- Performance that never deteriorates
- Perfect regularity and flatness
- Versatile (decking or tiling)
- Installation on pedestals or foundation screws

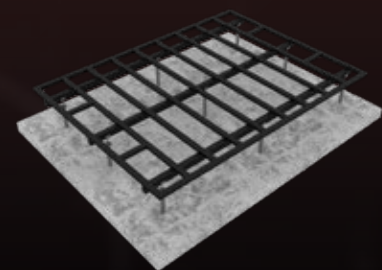
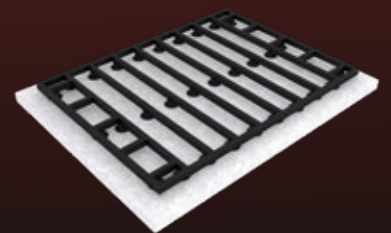

Perfect compatibility with
HYBRID clips
and Airspacer

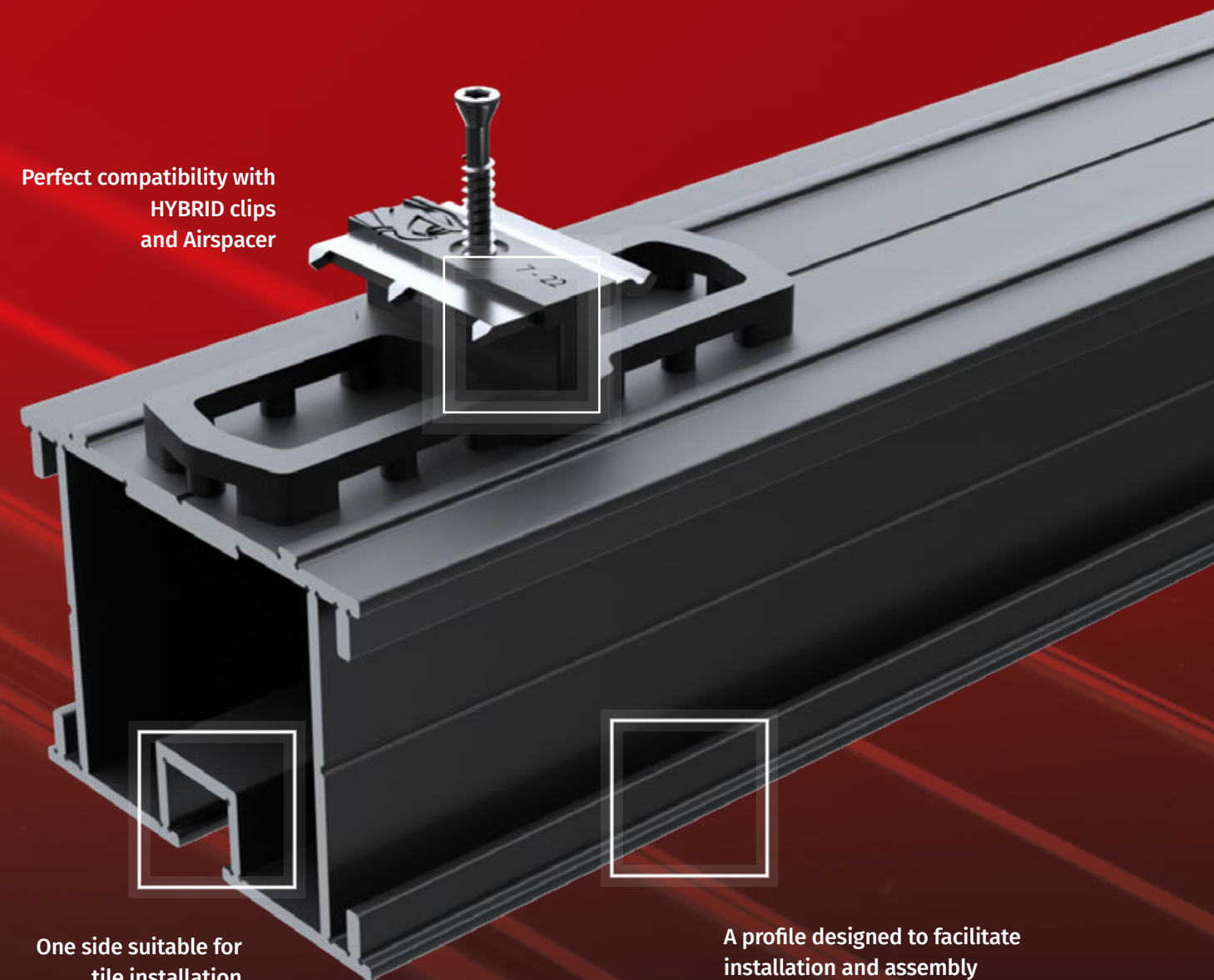

One side suitable for
tile installation

A profile designed to facilitate
installation and assembly



JOIST

40x24mm

200cm FD2278

400cm FD2097

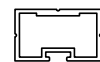

JOIST

60x40mm

200cm FD2277

400cm FD1892



JOIST

60x80mm

200cm FD2275

400cm FD1893



JOIST

60x120mm

200cm FD2276

400cm FD1894



MATERIAL	EN AW 6063 (TS) aluminum alloy Black	
FINISH	RAL 9005 matte lacquer finish QUALICOAT	
USE	Top side Bottom side	Decking installation Paving installation

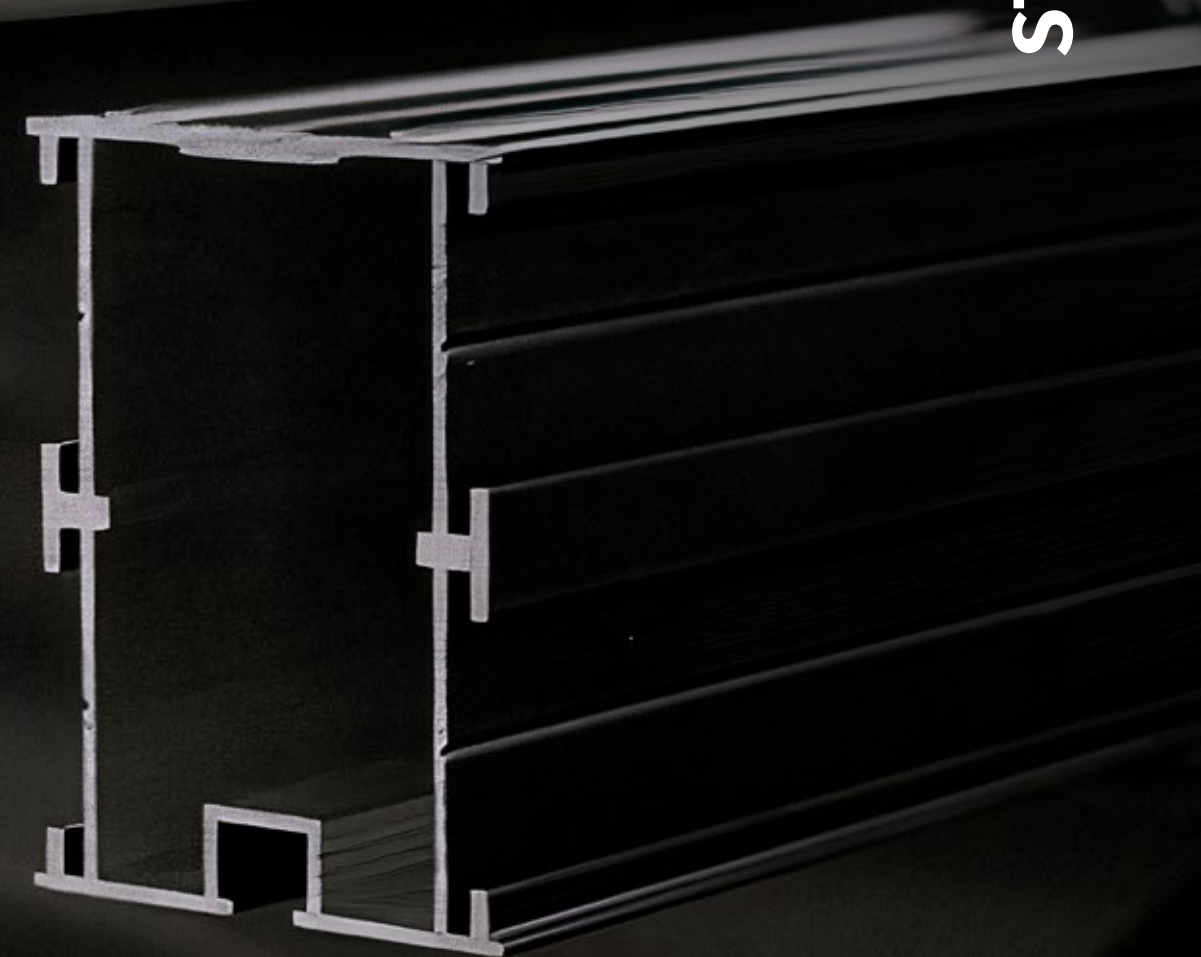

	40x24mm	60x40 mm	60x80 mm	60x120 mm
L 200 cm	FD2278 (1,5 kg)	FD2277 (2,3 kg)	FD2275 (3,5 kg)	FD2276 (4,9 kg)
L 400 cm	FD2097 (3 kg)	FD1892 (4,6 kg)	FD1893 (6,9 kg)	FD1894 (9,8 kg)
	 0,5M	 1 M	 2 M	 3 M



External corner bracket
FD2054

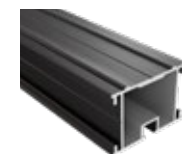

40x60mm



80x60mm



120x60mm



FD2054
(x20)

FD1898
(x20)

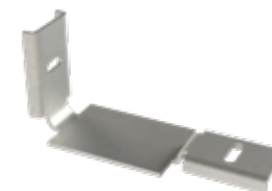

FD2094
(x10)



FD1897
(x10)



FD1899
(x10)



FD2214
(x8)



FD1903
(x100)

INTERIOR ANGLES

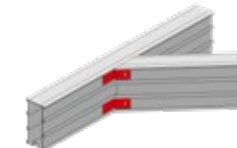
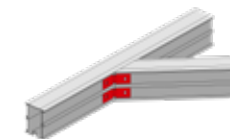

EXTERIOR ANGLES

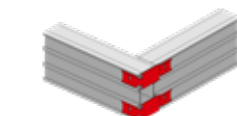
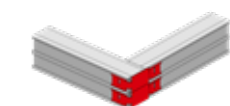
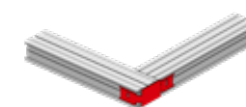

OVERLAY & ANCHORS

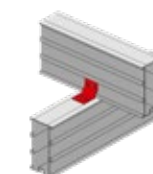
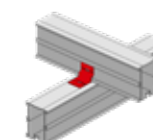
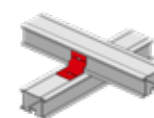

VERTICAL ANGLES

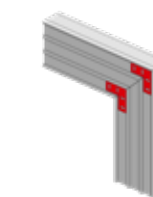
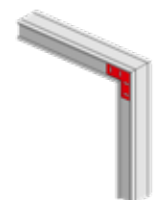

T-CONNECTIONS

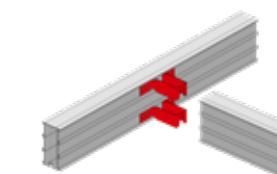
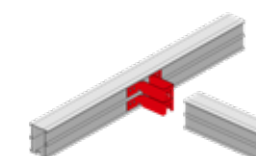

SINGLE SCREW (4.8 X 16 MM SELF-DRILLING)
FOR ALL ACCESSORIES



40x60mm



80x60mm



120x60mm

END JOINTS

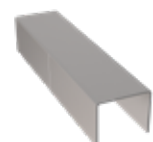

FD1896
(x4)

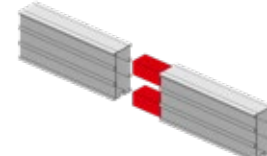
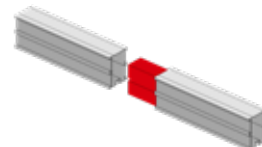
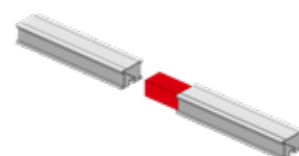

JOIST CAPS



FD2093
(x10)

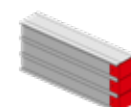

END CLIPS



FD2055
(x10)

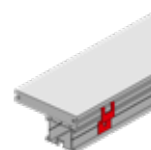

SINGLE SCREW (4.8 X 16 MM SELF-DRILLING)
FOR ALL ACCESSORIES



FD1903
(x100)



FINISHING CORNER
FD1938 (2 ML)

Joist splicing sleeve
FD1896



T-connection with OMEGA support
FD2214



Range of connections, fasteners,
and finishes STRUCTURAL



External corner bracket
FD2094



STRUCTURAL ACCESSORIES

Our joists have been designed with side guides that make it easy to build the components of your deck structure.

With the complete range of STRUCTURAL accessories that are easy to assemble and attach, the construction of various frames, connections, and finishing elements can be carried out quickly and accurately



XTEND

FD1895 (2 ML)

This aluminum support allows for optimal joining of decking boards with double fastening, without the need for double joists.

Easy assembly thanks to its design for convenient screw fastening.

Withstands loads in accordance with DTU requirements 43.1 and 51.4

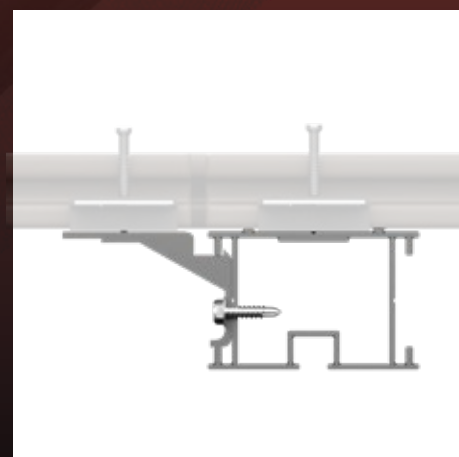

RECUTABLE

Available in 2-meter profiles, Xtend can be recut for optimized use depending on the type of installation joints and the width of the decking to be butt-jointed.

INSTALLATION WITH CLIPS

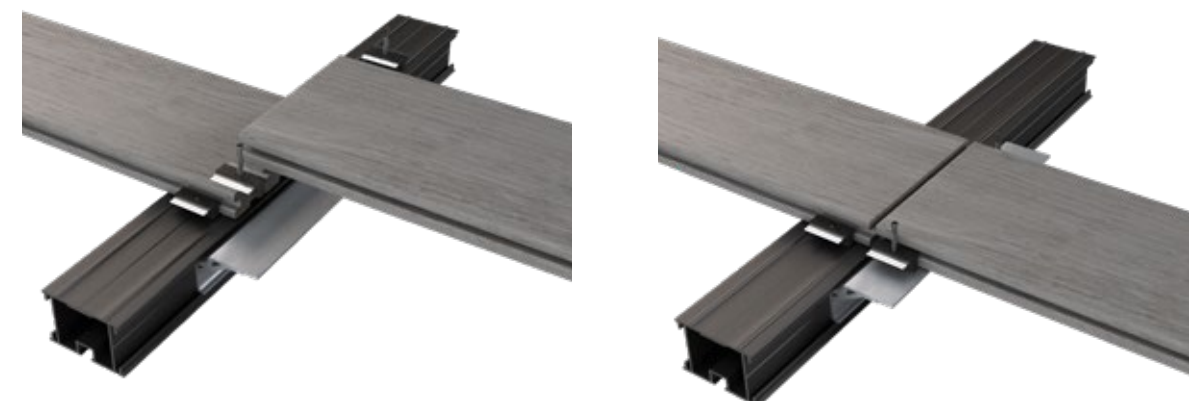

INSTALLATION WITH SCREWS



Xtend is compatible with the installation of boards with invisible side clips or with suitable through screws for aluminum structures.

STRUCTURAL
XTEND



CERAM

STRUCTURAL is reversible, offering an ideal and easy solution for laying **porcelain stoneware tiles**.

The joist frame allows for optimal adjustment and leveling.

This modular, load-bearing system allows for multiple geometries and facilitates the creation of finishing elements.

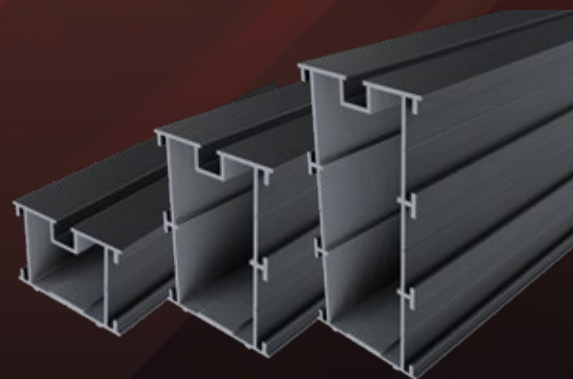

STRUCTURAL CERAM

FD2235
60x60 mm
Thickness. 2 mm
(x54)

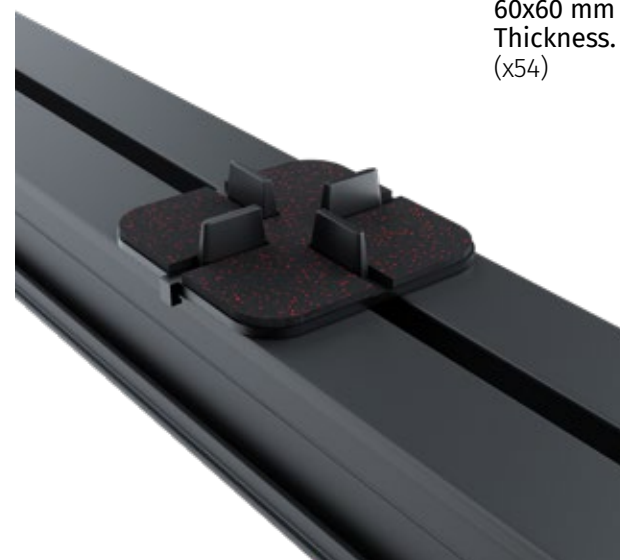

The spacers **fit into the groove of the joist and clip into place**. They slide for easy and precise installation of the decking.



The 3mm-thick **recycled rubber** pad supplied with each spacer provides **comfort and cushioning**.



Breakable wings to adapt the spacer to different tile laying configurations.

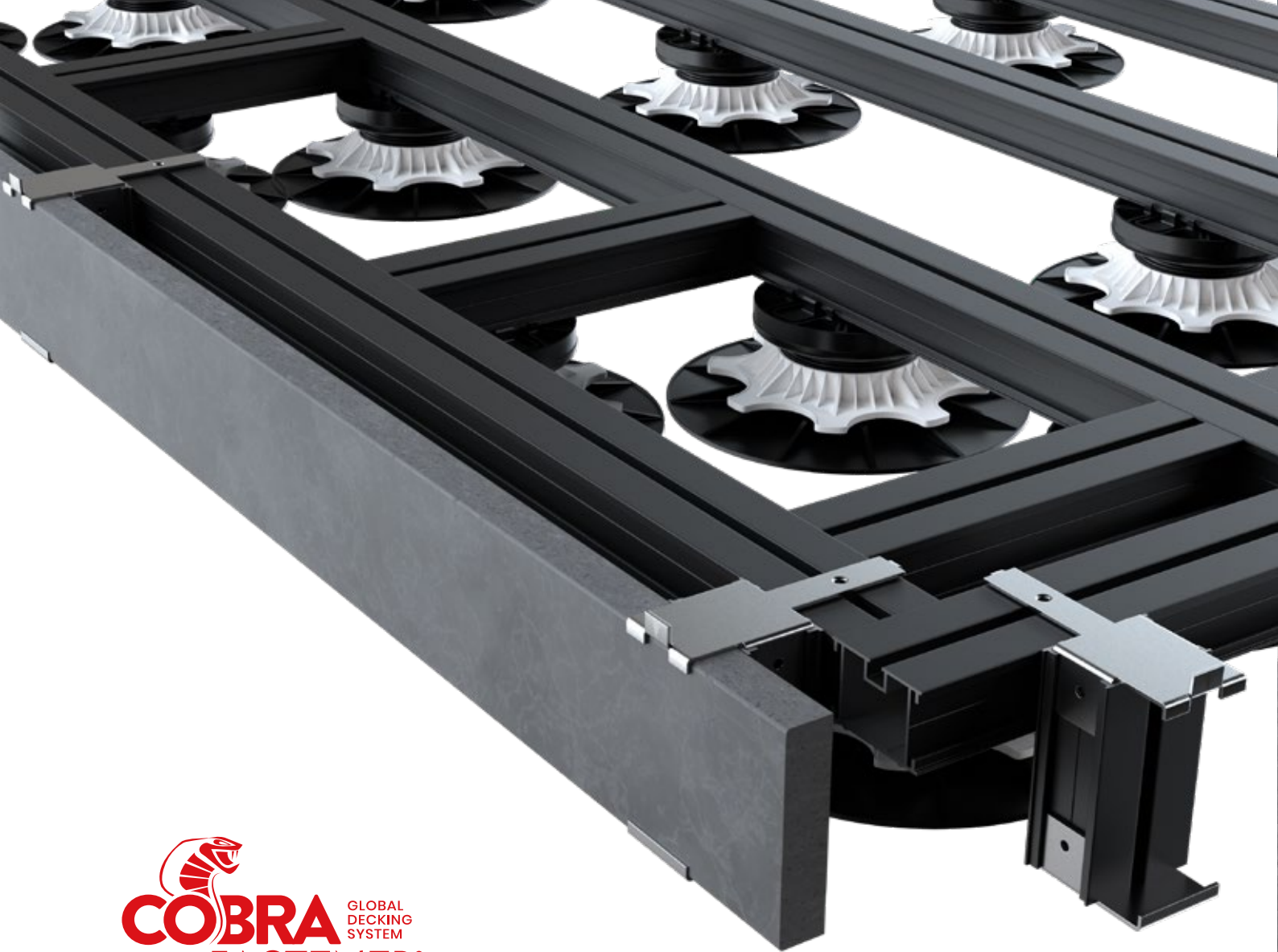

CERAM

The system of upper and lower hooks allows for the installation of tile skirting boards and adapts to many configurations.



FD2237
(x8)



FD2236
(x8)



STRUCTURES

DECKING PLOTS



A SOLUTION AGILE AND DURABLE

Whatever your decking project, whether decking or paving, adjustable pedestals have become an essential solution for outdoor flooring.

Sustainable products manufactured in France from recycled materials, NIVO pedestals can support heavy loads.

They allow for various elevations and meet numerous installation requirements.

They offer many advantages, such as avoiding heavy earthworks or the need for joints, and making the deck. Precisely level, create a usable surface without damaging a waterproof floor, simplify the passage of cables or pipes under the surface, facilitate the replacement of a slab, etc. They are resistant to UV rays and climatic variations.

Lightweight, rot-proof, and easy to use, NIVO pedestals comply with current regulations, such as DTU 43.1 and 51.4.

They ensure stability, aesthetics, and durability for your deck.

NIVO





PRECISE ROBUST PRACTICAL

- 800 kg compression load
- Weather and UV resistant
- 60 mm extensions to reach 530 mm
- Pre-assembled in the factory
- Packs of 10 pieces, shrink-wrapped



Installation of STRUCTURAL
joists by simple clipping

100% recycled
polypropylene

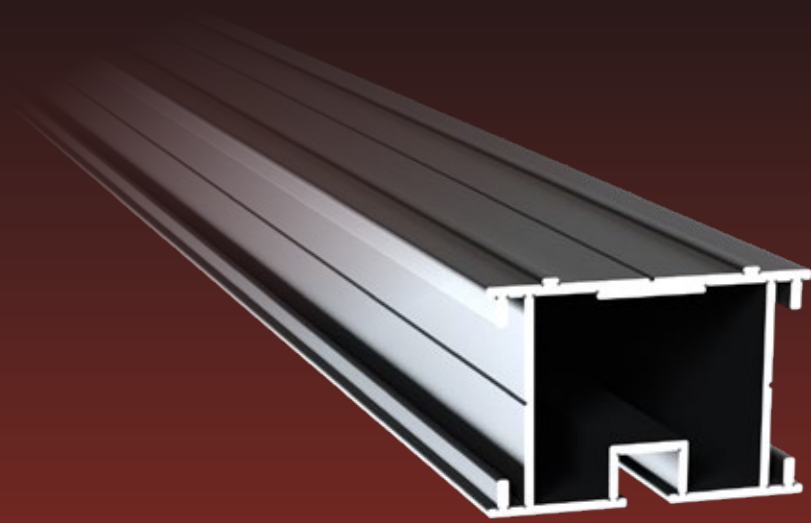

The **AL60 adapter** (FD0677) allows the STRUCTURAL joists to be clipped onto other pedestals available on the market (Jouplast, etc.).



STRUCTURAL JOISTS

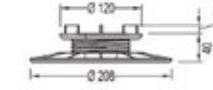

H 25 - 40 mm
FD2120

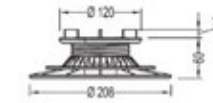

H 40 - 60 mm
FD2121

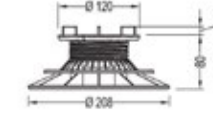

H 50 - 80 mm
FD2122

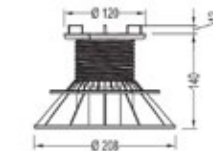

H 80 - 140 mm
FD2123

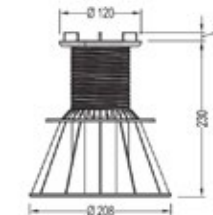

H 140 - 230 mm
FD2124



WOOD JOISTS

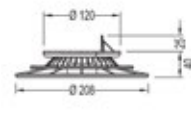

H 25 - 40 mm
FD0113

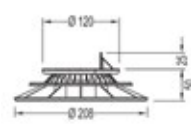

H 40 - 60 mm
FD0109

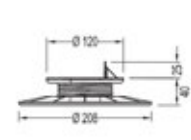

H 50 - 80 mm
FD0110

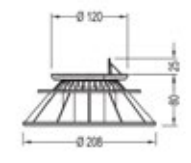

H 80 - 140 mm
FD0111

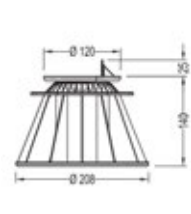

H 140 - 230 mm
FD0112

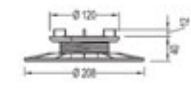

H 25 - 40 mm
FD0337

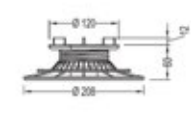

H 40 - 60 mm
FD0273

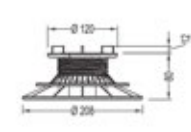

H 50 - 80 mm
FD0274

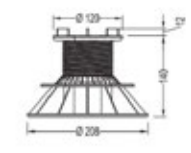

H 80 - 140 mm
FD0275



H 140 - 230 mm
FD0276

CERAM PAVING



- 1 **SHOCK ABSORBER PAD** FD0898
Provides cushioning and acoustic comfort under the decking. Th. 5 mm
- 2 **60 MM EXTENSION** FD0206
Stackable up to a maximum of 5 to reach a height of 530 mm
- 3 **SLOPE CORRECTOR** FD0338
Combined discs to correct slopes of 2 to 5%

STRUCTURES

FOUNDATION SCREW



A PRACTICAL & ECO-FRIENDLY FOUNDATION SCREW

The SPIRAL foundation screw is a galvanized steel pile with a thread designed to be driven into and securely anchored in the ground. It allows you to install a perfectly stable and level wooden or aluminum structure that can support heavy loads.

Installation is simplified thanks to the possibility of adjustments and corrections for imperfections. The foundation screw is suitable for all kinds of installations: deckings, swimming pools, jacuzzis, carports, shelters, etc.

Available in several sizes and for different uses, it meets the need to correct a steep slope, raise a structure, or create different levels of structure without complicating construction.

This solution is a perfect alternative to creating a concrete slab. Foundation work that is less expensive, less time-consuming, preserves the garden more, and promotes drainage in the soil. The type of soil will determine the type of screw to use.

SPIRAL





EFFECTIVE RESISTANT VERSATILE

- High compression loads
- Resistance to tearing
- Durable / Reinforced galvanized steel
- Penetrating tip
- No concrete slab
- Removable

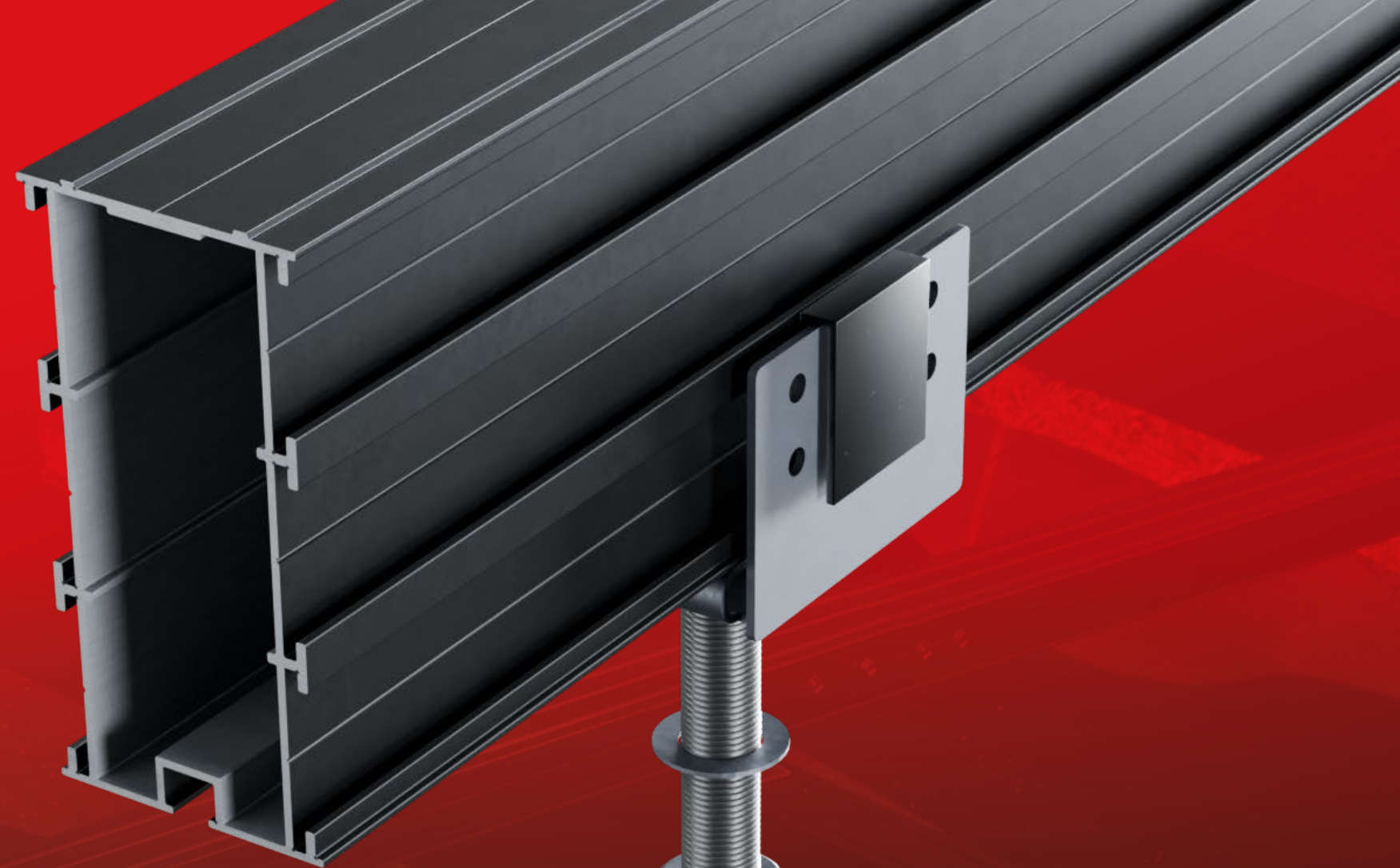

Z600 reinforced
galvanized steel

Up to 10kN
pressure resistance
in firm soil

FIRM GROUND & BACKFILLS

G-800

FD1577



80 cm

G-1200

FD1578



120 cm

G-1500

FD1806



150 cm

SAND & SOFT GROUND

S-1200

FD1807



120 cm

POSTS
(EXCLUDING
FENCE)

P-800

FD1808



80 cm



SPIRAL

CERTIFICATES

Material ISO 630 FE 360A
Hot-dip galvanization EN 1461
Reinforced galvanized steel Z600
Average thickness 70 µm, min.55 µm
Durability 50 years*

Manufacturing process ISO 9001:2015
Product EN 1090

Environmental performance ISO 14001



* In normal exposure conditions

FOUNDATION SCREWS



- | | | |
|---|--|--------|
| 1 | FLAT SUPPORT 90X90MM | FD1221 |
| 2 | ADJUSTABLE JOIST
SUPPORT | FD1809 |
| 3 | SPACER BRACKET
For adjustable joist support | FD2092 |

- | | | | |
|---|---|----------------------|------------------|
| 4 | U-SHAPED SUPPORT
POST
Central M16x50 fixing screw and
washers included | 90X90MM
120X120MM | FD1901
FD1902 |
| 5 | LEVELING DISC | | FD1904 |



ADAPTER FOR IMPACT WRENCH

- Connects the tool to the foundation screw
- M16 central fastening for easy, quick, and secure assembly
- 6 peripheral lugs
- Integrated spirit level
- M41 hexagonal center head
- Compatible with Milwaukee M18FHIWF1-122 or Makita TW1000 impact drivers

FD0616

MANUAL SCREWDRIVER BAR

- Kit consisting of a pre-drilled pole for adjusting the height of the bar
- 160 cm span
- 3 bolts + nuts to secure the tool to the screw
- The bar is adjustable during screwing to facilitate pushing

FD0615





ESSENTIAL & FUNCTIONAL

Building a durable decking is not limited to decking boards and their fastenings or the structure.

To ensure rigorous and compliant construction, installation accessories are functional elements that provide efficiency, ease of use, and precision.

Essential items in the Cobra range, such as sealing tape, various pads, and drilling aids, guarantee the longevity and aesthetics of your project.



BITUDECK

Waterproofing strip

- Increases the lifespan of wooden joists
- Complies with DTU 51.4 requirements
- Waterproof - Absorbs sound resonance
- Matte black color to prevent light reflections between boards
- Resistant to tearing, deformation, and temperature variations
- Easy and convenient to use
- Length: 10 meters
- **FD0145 : 75 mm x 1,5 mm**
- **FD2077 : 100 mm x 1,5 mm**

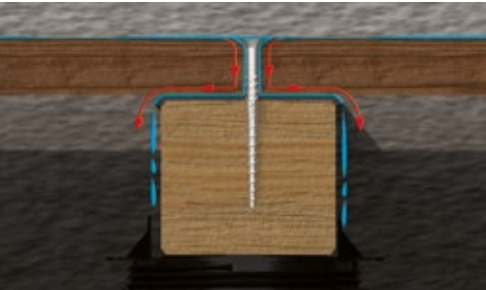

BITUDECK adhesive sealing tape significantly extends the life of your wooden structure by effectively protecting it from moisture



Top side	Elastomeric bitumen self-adhesive
Bottom side	HDPE Film
Tensile strength	150 N
Tear resistance at the nail	25 N
Operating temperature	-20°C à +70°C
Storage temperature	+15°C
Water resistance	0.3 MPa, 120 min
Adhesive strength	1.5



GEOTEXTILE 100 GR/M²

Practical & Easy

- Polypropylene
- Opaque black
- Prevents weed growth
- Rot-proof
- Resistant
- Simply lays on the ground, soil, or grass
- Water permeable, promotes drainage
- Thickness 0.55 mm – 2 x 10 meters

FD0607

PROPERTIES

Weight	Thickness	Resistance tear resistance*
100 g/m²	0.55 mm	0.413 kN
<hr/>		
Tensile width**	Elongation at maximum tensile load	
13.6 kN/m	132%	

*ISO 12236 : 2006
**ISO 10319 : 2015



DECKING ACCESSORIES



POWER GRIP Deck clamp

- Holds up to 4 rows of boards
- Allows for quick and precise screw fastening of clips
- Pack of 2 clamps with 4 adapters for decking
- 60 cm carbon steel bar
- Ergonomic handle with grip

FD2098

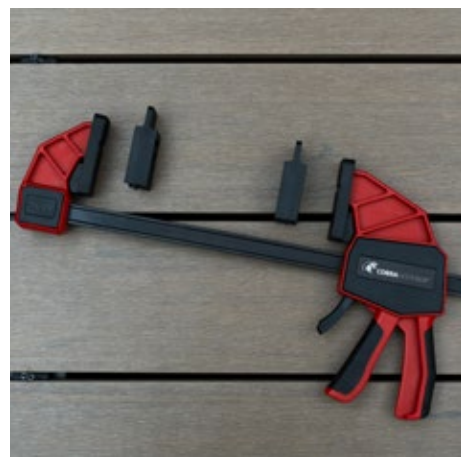

COBRA WRENCH Board straightener

- Allows you to straighten warped deck boards
- Easy to use, for right- or left-handed users
- Ergonomic and lightweight tool
- Supplied with different sized pins, adjustable to the dimensions of the joists

FD0216

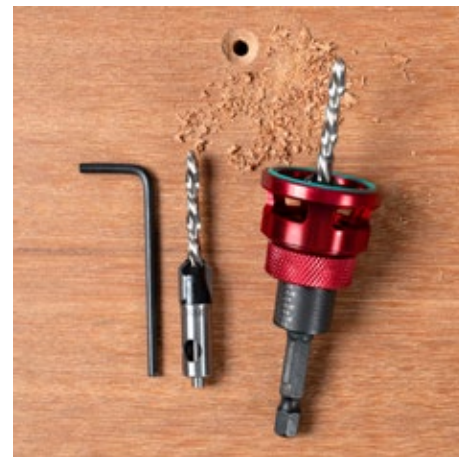
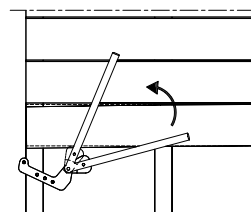

COBRA DRILL BIT Pre-drilling

- Drills and countersinks the board for a perfect finish
- Aluminum stop collar with bearing
- Non-marking rubber shock-absorbing ring
- Adjustable countersink and drill bit with included hex key
- 2 high-strength HSS steel drill bits
- Carbon steel hex shank, 45–48 HRC

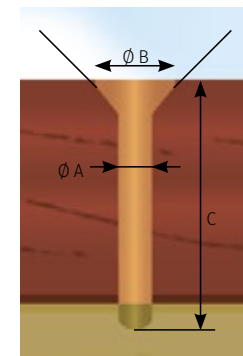

FD1579

	A	B	C max
Drill #1	3,6 mm	9 mm	35 mm
Drill #2	4,0 mm	9 mm	35 mm



COBRA LINER Drilling template

- Ensures perfect alignment of screws when screwing down decking boards
- Guarantees that screws are 20 mm from the edge of the boards, in accordance with DTU 51.4
- Adjustable to all deck board widths
- Saves time, easy to use
- Supplied with 4 DECK SPACER spacers

FD0603

DECK SPACER Even joints

- Ensures regular spacing between boards for expansion and contraction of the wood, in accordance with DTU 51.4 requirements
- Guarantees linear expansion clearance at the ends of composite wood boards
- 4 fins with 4 different spacings

FD0604

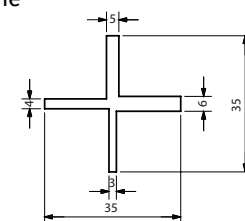



FLATPAD

- Quick and accurate leveling
- Allows for corrections of thicknesses ranging from 2 to 5 mm
- Rot-proof, solid, and UV-resistant

FD0135

RUBBERPAD

- Increases the lifespan of your structure
- Allows rainwater to flow under the joists
- Protects the joists from ground moisture
- Rot-proof
- Shore hardness: 55A
- Density: 730 kg/m3



8x90x90 mm (24 pcs) **FD0210**

3x60x90 mm (60 pcs) **FD0609**



WEDGEPAD

- Quick and accurate leveling
- Allows thicknesses of 10 to 30 mm to be corrected
- Rot-proof, solid, and UV-resistant
- Can be screwed or glued

FD0610

My Deck Planner

CREATE YOUR DECKING PROJECT EASILY

An online tool that simplifies the design of wooden deckings. Draw, configure, and visualize your project with a customized plan and a precise list of materials.

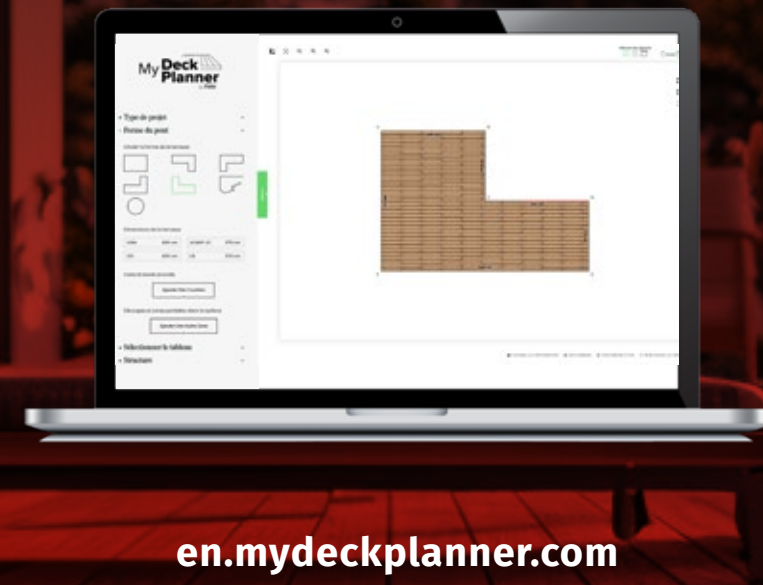

en.mydeckplanner.com





cobrafastener.com